

# valvole manuali

hand valves  
vannes manuelles  
válvulas manuales

## Circle



|                   | White         | Chrome | Silver<br>"spazzolato" | Colors<br>"pastels, specials" |
|-------------------|---------------|--------|------------------------|-------------------------------|
|                   | Cod.          | Cod.   | Cod.                   | Cod.                          |
| Squadra           | AICP1RS0102B  | Al...C | Al...Y                 | Al...S                        |
| Reversa           | AICP1RR0102B  | Al...C | Al...Y                 | Al...S                        |
| Corner (valv. DX) | AICP1RCD0102B | Al...C | Al...Y                 | Al...S                        |
| Corner (valv. SX) | AICP1RCS0102B | Al...C | Al...Y                 | Al...S                        |
| Doppia (50 mm)    | AICP1RP0102B  | Al...C | Al...Y                 | Al...S                        |

Per versione mista senza raccordo "T" - For mixed version without "T" joint - Pour version mixte sans raccord "T" - Para version mixta sin racor "T"

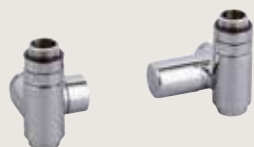

|                |               |        |        |        |
|----------------|---------------|--------|--------|--------|
| Mix (valv. DX) | AICP1RMD0102B | Al...C | Al...Y | Al...S |
| Mix (valv. SX) | AICP1RMS0102B | Al...C | Al...Y | Al...S |

## Dado



|                   | White         | Chrome | Silver<br>"spazzolato" | Colors<br>"pastels, specials" |
|-------------------|---------------|--------|------------------------|-------------------------------|
|                   | Cod.          | Cod.   | Cod.                   | Cod.                          |
| Squadra           | AICP7RS0102B  | Al...C | Al...Y                 | Al...S                        |
| Corner (valv. DX) | AICP7RCD0102B | Al...C | Al...Y                 | Al...S                        |
| Corner (valv. SX) | AICP7RCS0102B | Al...C | Al...Y                 | Al...S                        |

## note

Tutte le valvole hanno attacchi al radiatore da G 1/2"  
All valves have connections to the radiator of G 1/2"  
Toutes les vannes ont attaches radiateur G 1/2"  
Las válvulas tienen conexiones con el radiador de G 1/2"

Tutti i prezzi si riferiscono alla coppia valvola, detentore – raccordi inclusi  
The prices are referred to the pair of valves – joints included  
Tous les prix se réfèrent au couple vanne, détendeur – raccords inclus  
Los precios se refieren al par de válvulas – racors incluidos

CIRCLE ha attacchi all'impianto da 24-19; DADO da G 1/2"  
CIRCLE has connections to the installation of 24-19; DADO of G 1/2"  
CIRCLE a attache installation 24-19; DADO de G 1/2"  
CIRCLE tiene conexiones con la instalación de 24-19; DADO de G 1/2"