



- Radiation
- Inertia
- Air quality
- Quick heating
- Ease of use



# Dolce

## WIFI

DUAL THERM ELECTRIC RADIATOR WITH WI-FI CONTROLS AND DOUBLE HEATING SYSTEM: THE DRY INERTIA OF THE REFRACTORY STONE JOINS THE RADIANT FRONT RESISTANCE FOR RAPID HEATING AND EXCELLENT THERMAL COMFORT.

COLORS AVAILABLE



## CARATTERISTICHE TECNICHE

- Thanks to the Deltacolor Confort app, the radiators can be controlled and programmed remotely
- Personalized comfort room by room: the app informs you about the room temperature and therefore you can adjust the desired temperature for each room.
- Smart heating scheduling: set a program that fits to your lifestyle. Choose the time and rooms you want to heat.
- Monitoring of consumption: Deltacolor Confort helps you improve your energy efficiency. Check on the App the history of the electrical

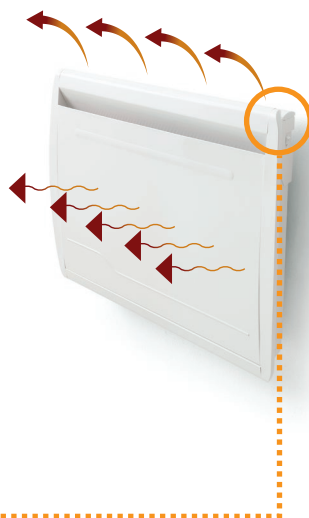

consumption in kWh of the radiators in each room and optimize your heating program.

- Double resistance electric radiator: a refractory stone to accumulate and release a pleasant sensation of heat. A heating film on the front surface of the radiator for rapid space heating.
- Curved sheet metal frame, white color
- Touch screen digital controls in the high shoulder integrated with the radiator body with LED screen with WIFI DIRECT HOME AUTOMATION (direct connection to the home router without auxiliary bridges).
- Wi-Fi thermostat compatible with Amazon Alexa and Google Assistant. It therefore allows heating control via voice commands.
- Comfort, Eco, Frost and Stand-by modes
- Weekly programming
- ASC - Adaptive start control: to obtain the desired temperature, when you wish
- Window opening detection sensor
- Smart Lock
- Consumer behavioral indicator
- Consumption meter on a daily, weekly, monthly and annual basis
- Adjustment from 0°C to 30°C
- Pilot wire 0 orders
- Available in 3 powers
- Quick and easy installation thanks to the kit for wall mounting included.



## TECHNICAL DETAILS

### FEATURES

POWER w	A mm	B mm	C mm	WEIGHT kg
1000 + 150 (front resistance)	600	550	100	10,7
1500 + 150 (front resistance)	750	550	100	13,5
2000 + 150 (front resistance)	900	550	100	17

### TECHNICAL GUIDE

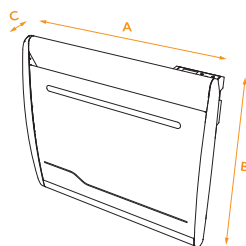

### INTEGRATED CONTROLS

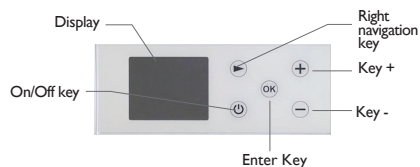

#### THERMOSTAT FEATURES

- Functions: ECO and (ASC) Adaptive heating control.
- Program selected for Chrono mode.
- Time or temperature configured.
- Daily program in Chrono mode.
- Modes: Stand-by, Chrono, Frost protection, Night, Comfort, Pilot wire.
- Functions: detection of window opening and key lock
- Day of the week
- Consumption indicator



IP24-Class II



55

dolce wifi

